

AUCTION INFORMATION

THE AUCTION

Bob Perani, a noted nationwide collector, has decided to sell his personal collection on display at his mall.

AUCTION DATES

Tuesday & Wednesday, July 7th and 8th at 10:00 a.m. daily

AUCTION LOCATION

In the Dort Mall, 3600 S. Dort Highway, Flint, Michigan. Just off of I-69.

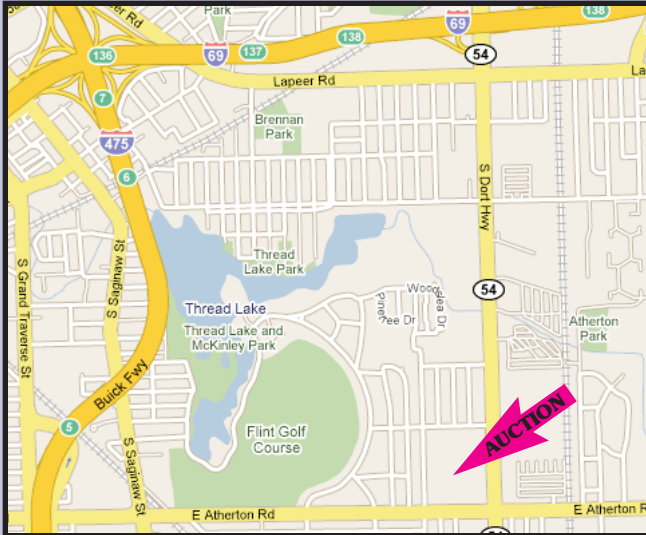

AIR TRAVEL

Flint's Bishop Airport is close by. Detroit's Metro Airport is approx. 1 hour away.

FOR MORE INFORMATION

Go to nortonauctioneers.com for more photos or send \$10.00 for color brochure.

CAR RENTAL

HERTZ 800-654-3131 AVIS800-331-1212
 BUDGET 800-527-0700 NATIONAL.....800-227-7368
 DOLLAR 800-421-9633 ALAMO800-327-9633
 (Call travel agent for local car rental)

TRAVEL AGENCY

Adventure Travel is the official travel agent for all NORTON Auctions. Competent, trustworthy and economical service for all plane, train, hotel and car reservations. Phone 877-617-9990 or 517-279-9990. Advise you are attending a NORTON Auction for prompt service.

LODGING

Auction Host Headquarters

Holiday Inn Express
 1150 Robert T. Longway
 Flint, MI 48503
 (Just off 475 • Exit 8A off I-69 N. of 475)

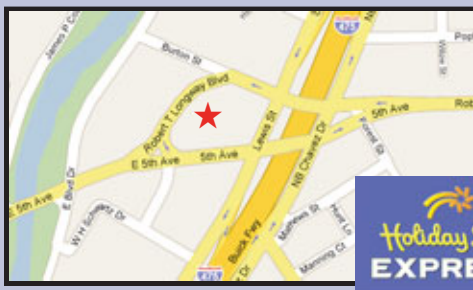

Special Norton Auction Rate of \$75⁰⁰ - Single or Double.
 Use code NOR

TERMS

Our terms are strictly adhered to, so come prepared! All items must be paid for in full on day of sale! No items can be removed until settled for in full. Payment must be made by cash, certified or cashier's check. **NO** company or personal checks will be accepted **UNLESS** accompanied by a letter of credit from your bank which **GUARANTEES** your check up to a specific amount! All items are sold as is, where is, without any warranties whatsoever whether expressed or implied. Buyer is responsible for any and all applicable taxes. Your banker may FAX a letter of credit to 517-279-9191 for prior approval.

Although statements made in this catalog and those made by the auctioneer have come from what are thought to be reliable sources, purchaser must understand he is buying property entirely upon his own examination and opinion. Any announcements made sale day take precedence over printed matter, regarding condition and description of enclosed items.

NORTON AUCTIONEERS Pearl at Monroe Coldwater, MI 49036 RE: (Bidder's Name)	YOUR BANK LETTERHEAD	DATE
SAMPLE		
Dear Sirs: This letter will serve as notification that our bank will irrevocably honor and guarantee payment of any check written by (Your Name) up to the amount of (\$ Amount to be Guaranteed) and drawn on this bank's account number (Your Account Number). This guarantee is for purchases at your Auction held in Flint, Michigan, Tuesday & Wednesday, July 7th and 8th, 2009.		
Sincerely,		
_____ Bank Officer's Signature & Title		
Phone	Home Phone	

BUYER'S PREMIUM

A premium of 10% (ten percent) of the successful bid price will be added to the bid as part of the total price.

REGISTRATION

You may register for a buyers number during the preview inspection hours. Be sure to bring your bank letter of guarantee if it has not already been sent to our offices!

SALES TAX

No sales tax will be charged as this is considered a casual sale.

PREVIEW INSPECTION

Monday July 6th from 2-6 p.m. and auction mornings at 8:30 a.m.

INFORMATION

David A. Norton at Norton Auctioneers M-F 10 a.m.-4p.m. (517) 279-9063 or Jenny Rose, assistant to Mr. Perani, at (248) 891-9453.

REMOVAL

2 p.m.-7 p.m. auction days and July 9, 10, & 11, 9 a.m.-5 p.m. daily.

SHIPPING

UPS Store on Site. For packing and shipping call Les Beare, The UPS Store, Fenton, MI (810) 750-2920.

ABSENTEE BIDDING

See requirements on our website: nortonauctioneers.com.

DIRECTIONS TO:

Holiday Inn Express-Flint
 1150 R.T. Longway-Flint, MI 48503

From The North I-75:

Take I-75 S To I-475-S To Exit 8-A Longway. Go To 1st Light Turn Right. Hotel Is On The Left.

From The South I-75:

Take I-75 N To I-475-N To Exit 8-A Longway. Go To 2nd Light Turn Left. Hotel Is On The Left.

From The East I-69:

Take I-69 W To I-475 N To Exit 8-A. Go To 2nd Light Turn Left. Hotel Is On Left.

From The West I-69:

Take I-69 E To I-475 N To Exit 8-A. Go To 2nd Light Turn Left. Hotel Is On Left.

From Bishop Airport:

Take A Right Out Of Airport Drive, Take To I-75 N To I-69 E To I-475 N To Exit 8-A. Go To 2nd Light Turn Left. Hotel Is On Left.